



PARK BRIDGE SPOOR NOORD - 06.057

Program

Complete mission of the architectural and structural design of a bicycle and pedestrian bridge.

Concept

The Park Bridge connects "het Eilandje" with Park Spoor Noord, areas both historically linked to the old port of Antwerp. Boats would alight at Eilandje, and their goods would be transhipped at the railyard of Spoor Noord. Today, both areas form new urban landscapes with a variety of functions and different characters. Together with the new bridge, they make up the new identity of northern Antwerp. Situated at the end of the Leien (city boulevards), the bridge functions as a node of urban flow. It is the gate through which one enters the city. For this reason we chose to design it as an independent object, with a constantly changing appearance based on the viewer's direction and standpoint. To those passing through, the bridge offers an extraordinary experience. The surroundings enter the otherwise closed structure through the pattern of openings, and flood the interior with a marvelous play of light and shadow. At night, the whole lights up as a luminous lantern. The steel box girder spans 67 m and is shaped analogous to the typology of a 'bowstring bridge'. This design makes that forces work like in an arch bridge: the top flange is the bow, the bridge deck the tractor and the side plates the pendants. This structural principle allows that the side plates can be very thin (12 to 15 mm) and gives a great freedom for making openings. Lighting, rain drainage and parapet are all integrated into the unique aesthetic.

Distinctions

Winner 'Open Oproep' Flemish State Architect

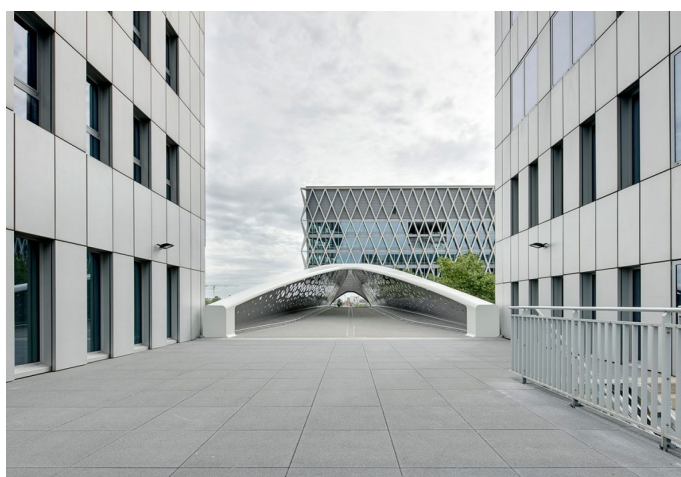

Study:	2007-2011	Length:	70 m
Execution:	2014 - 2016	Total budget:	1.100.000 € Vat Excl.
Architect:	Ney & Partners	State:	Completed
Client:	City of Antwerp - AG Vespa	Images credits:	Bart Gosselin - Stijn Bollaert
Site:	Antwerp, Belgium	Copyright:	Ney & Partners